



Norwich Western Link

Transport Assessment

Appendix 10: J21 (A1270/B1149)

Junction Improvement Scheme

Author: WSP

Document Reference: 4.01.10

Version Number: 00

Date: March 2024



Contents

1 Mitigation Proposals..... 3

Figures

Figure 1 A1270/Brewery Lane Junction - Northern Arm Emerging NCC Capacity Enhancement Scheme 4

Figure 2 A1270/Drayton Lane Junction - Southern Arm Emerging NCC Capacity Enhancement Scheme 5



1 Mitigation Proposals

- 1.1.1 The plans shown in Figure 1 and Figure 2 present emerging baseline capacity enhancement proposals on the local highway network at Junction 21 of the Transport Assessment (A1270/B1149 Junction).
- 1.1.2 Figure 1 shows the B1149 Brewery Lane northern arm proposal with additional traffic lane and ghost island layout.
- 1.1.3 Figure 2 shows the B1149 Drayton Lane southern arm proposal with additional traffic lane and ghost island layout.

Figure 1 A1270/Brewery Lane Junction - Northern Arm Emerging NCC Capacity Enhancement Scheme

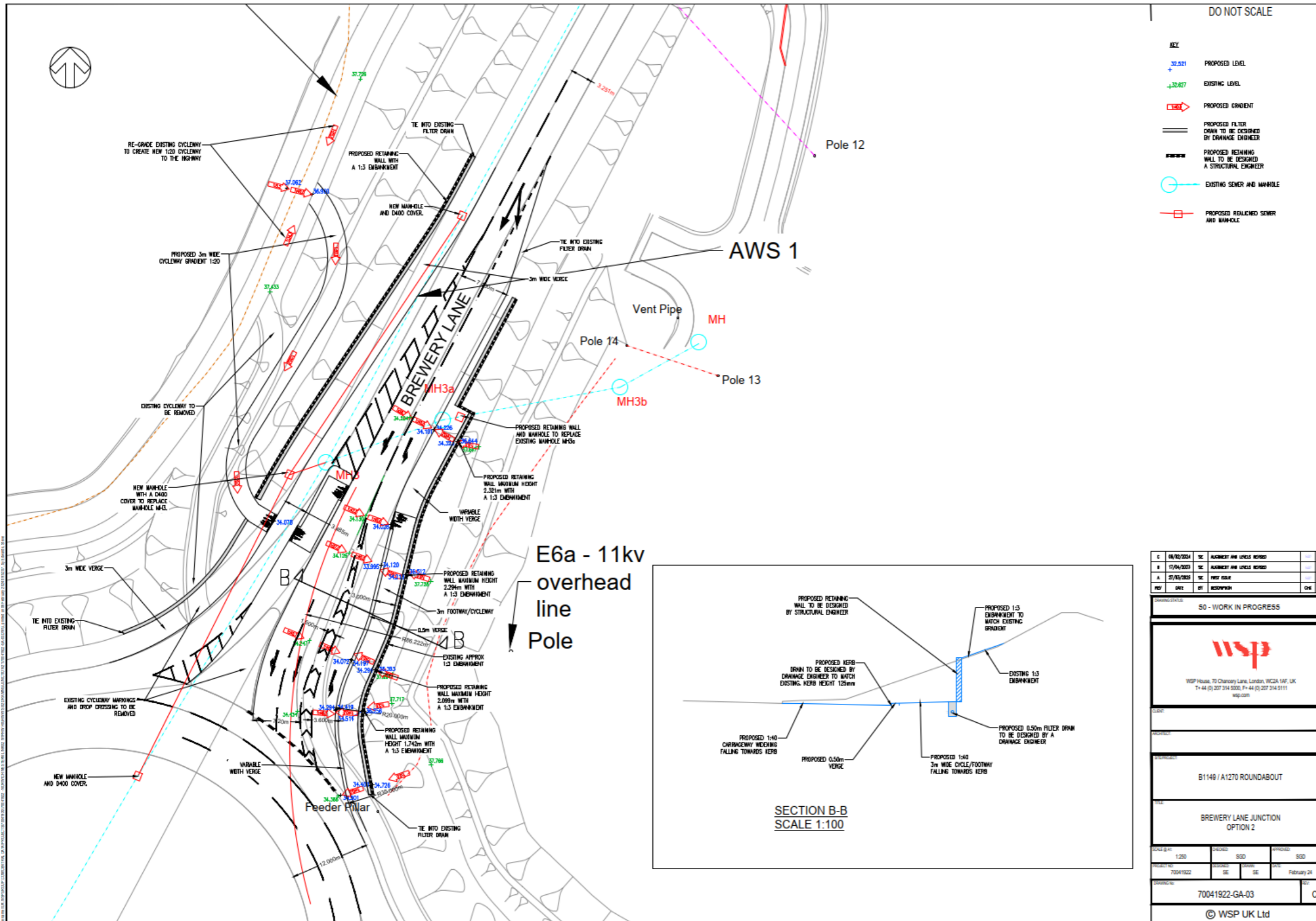

Figure 2 A1270/Drayton Lane Junction - Southern Arm Emerging NCC Capacity Enhancement Scheme

